

DESIGN acc.to B16.34		
PRESS. 200Bar	TEMP.-196 to 250°C	
PRESSURE TEST acc.to BS 6364		
BODY hydr.	SEAT hydr.	SEAT air
517 Bar	379 Bar	6 Bar

WEIGHT=N/A

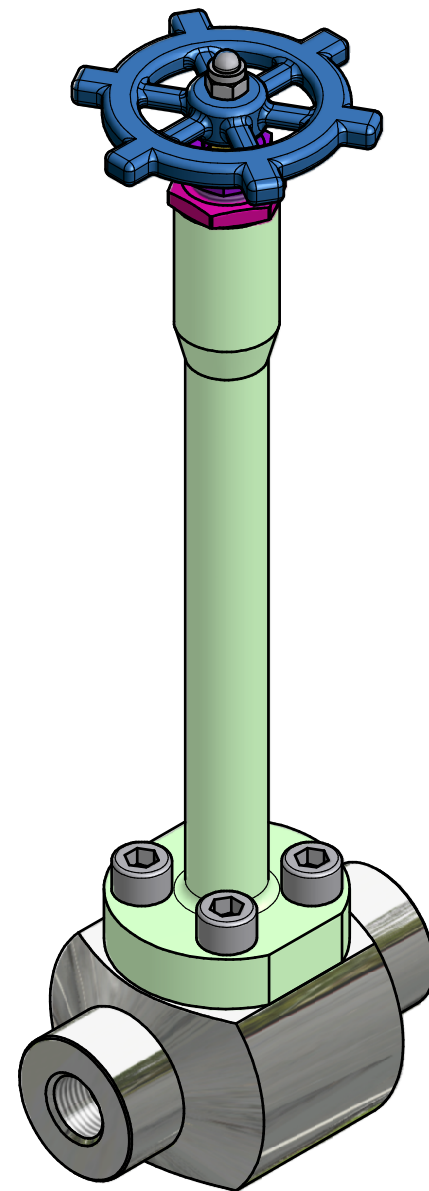
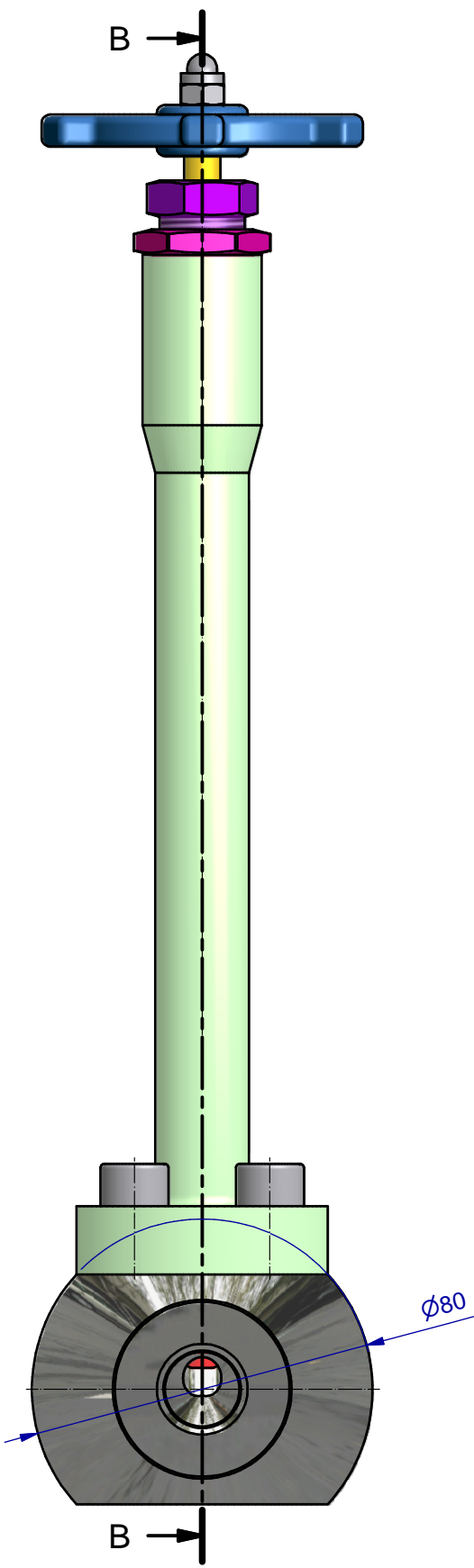
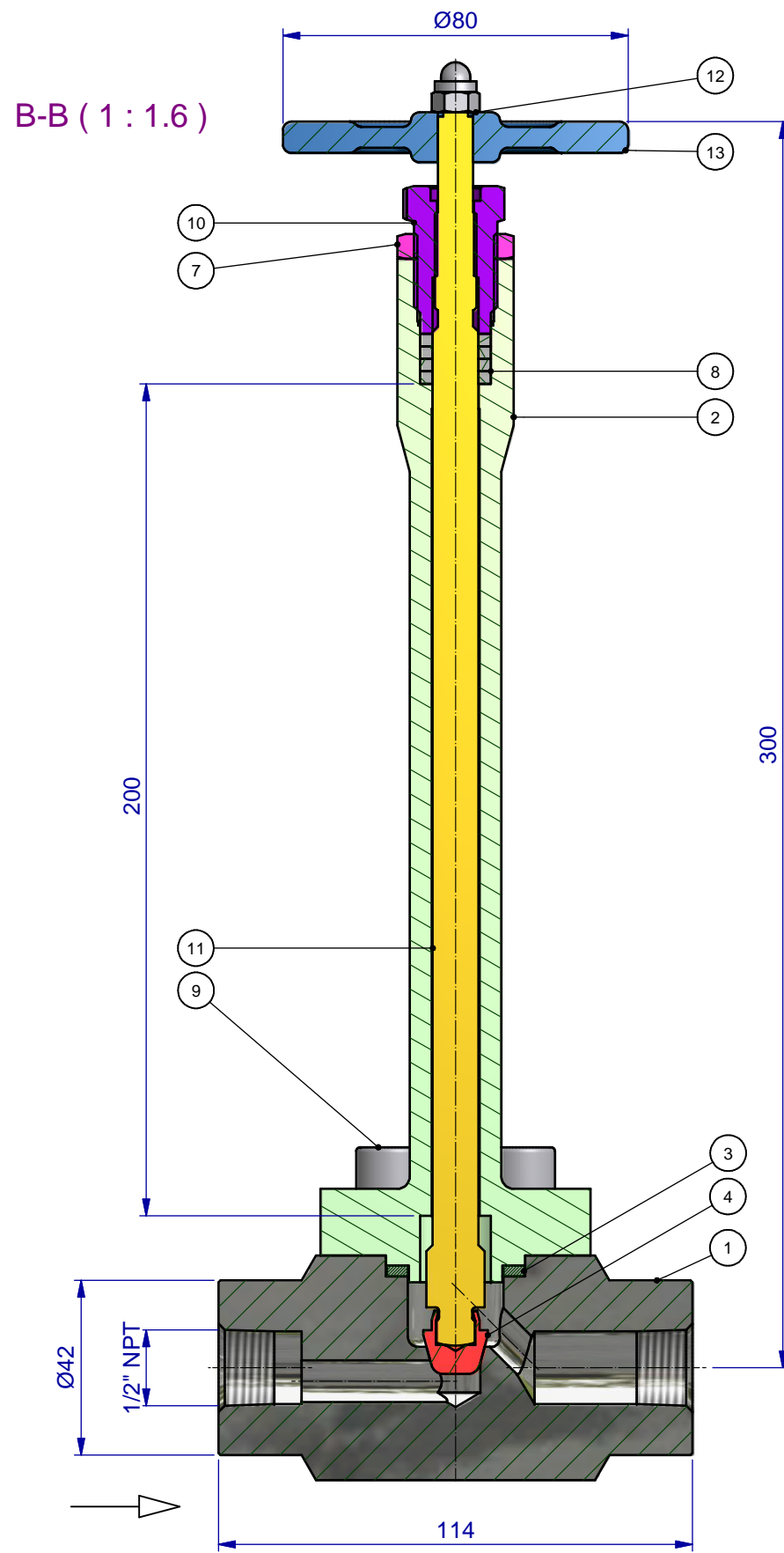

Parts List			
ITE	QTY	DESCRIPTION	MATERIAL
1	1	Body	SS 316/316L
2	1	Bonnet	SS 316/316L
3	1	Gasket	316/GRAPHITE
4	1	Needlepoint	SS 316/316L
7	1	Locking nut	SS 316/316L
8	4	Packing	Graphite
9	4	Screw	SS 316 SH
10	1	Gland	SS 316/316L
11	1	Stem	SS 316/316L
12	1	Nut	SS 316/316L
13	1	Handwheel	SS 316/316L

Size/Description/Rating/Ends:
Cryogenic needle valve 1/2"- NPTF 2500 lbs

Drawing No:
57150-00

MERWEDE
 VALVES

HARDINXVELD - GIESSENDAM
 THE NETHERLANDS

Design:	jhvanvliet	20-9-2013	Scale: 0,62:1
Approved:			Revision: 0
<small>This document remains the property of Merwede Valves BV. All rights reserved. This document or any part thereof may not be made public or disclosed, copied or otherwise reproduced or used in any form or by any means, including but not limited to the use herof for the design and manufacturing of identical or similar parts or products, without prior permission in writing from Merwede Valves BV.</small>			A3

T:\Inventor\Models\Needle\DN25\57150-00-00.iptw 2-9-2013